

Landscape Details

to be read in conjunction with the Landscape Drawings

Clongriffin Sustainable Living

Ronan Mac Diarmada & Associates

Landscape Architects & Consultants



Sedum/Green Roof

- **Drainage:** Vegetative roof drainage design must both maintain optimum growing conditions in the growth medium and manage heavy rainfall without sustaining damage due to erosion or ponding of water.
- **Plant nourishment and support:** The engineered medium must be carefully designed to provide for excellent plant growth, no wind scouring, and proper water holding capacity.
- **Protection of underlying waterproofing systems:** Vegetative roof assemblies must protect the underlying waterproofing system from human activities (including the impact of maintenance) and biological attack, and solar degradation. A capillary break immediately above the membrane is required for most membranes.
- **Waterproofing systems:** Waterproofing is critical for protecting the structure from water intrusion.
- **Insulation systems:** Insulation is critical for saving energy.



Extensive Vegetation (Sedums, etc.)
Growing Media
Filter Fabric
Moisture Retention / Drainage Panel
Insulation
Root Barrier
Protection Course and Capillary Break
Waterproofing Membrane (hot rubberized asphalt depicted)
Substrate (concrete deck depicted)

Option 1.

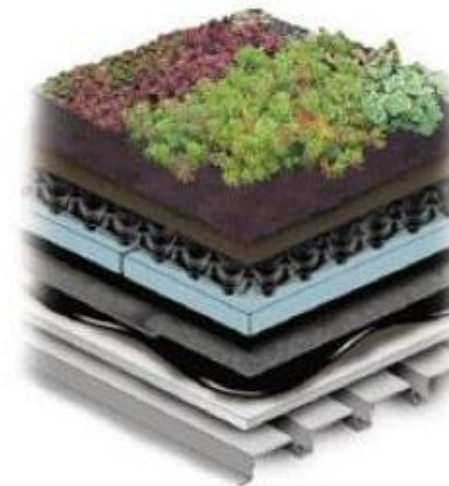

Extensive Vegetation (Sedums, etc.)
Growing Media
Filter Fabric
Moisture Retention / Drainage Panel
Insulation
Root Barrier
Protection Course and Capillary Break
Waterproofing Membrane (hot rubberized asphalt depicted)
Substrate (metal deck with gypsum board depicted)

Option 2.



RMDA

LANDSCAPE ARCHITECTS & CONSULTANTS

Sedum/Green Roof



- The root system: Sedum has very shallow roots, a key requirement for an extensive green roof, considering the modest depth of the substrate layer.
- Sedum is also drought-resistant
- Sedum needs relatively little nutrients and maintenance compared to other types of plant
- Sedum is very resilient to diseases and insects
- Sedum is also very adaptable: due to its capacity to adapt its metabolic system in periods of drought, it is able to survive in extremely dry conditions where other types of plants would die. And furthermore, Sedum recovers remarkably quickly as soon as water becomes available again.

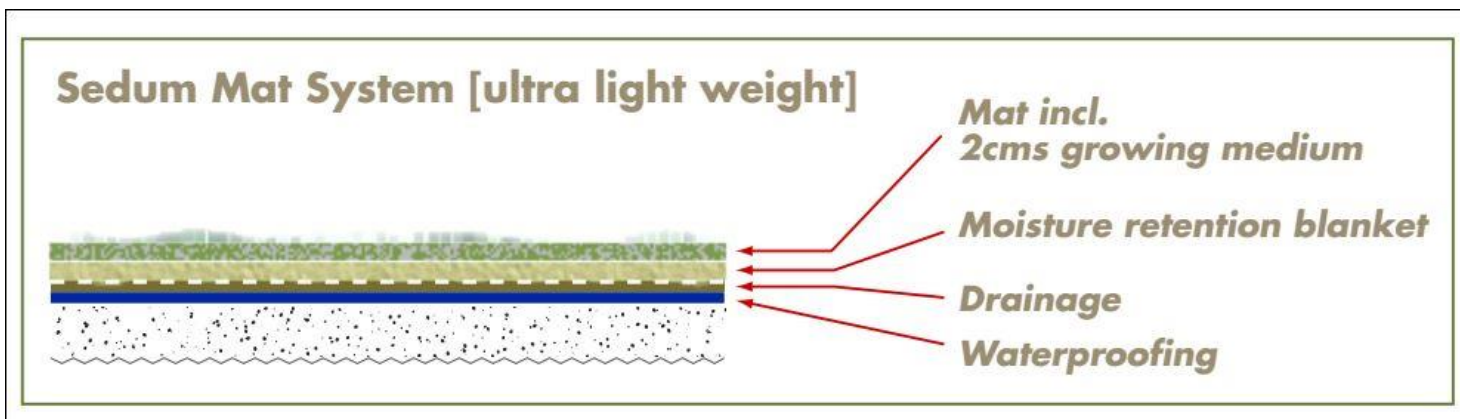

RMDA

LANDSCAPE ARCHITECTS & CONSULTANTS

Rain Garden Detail

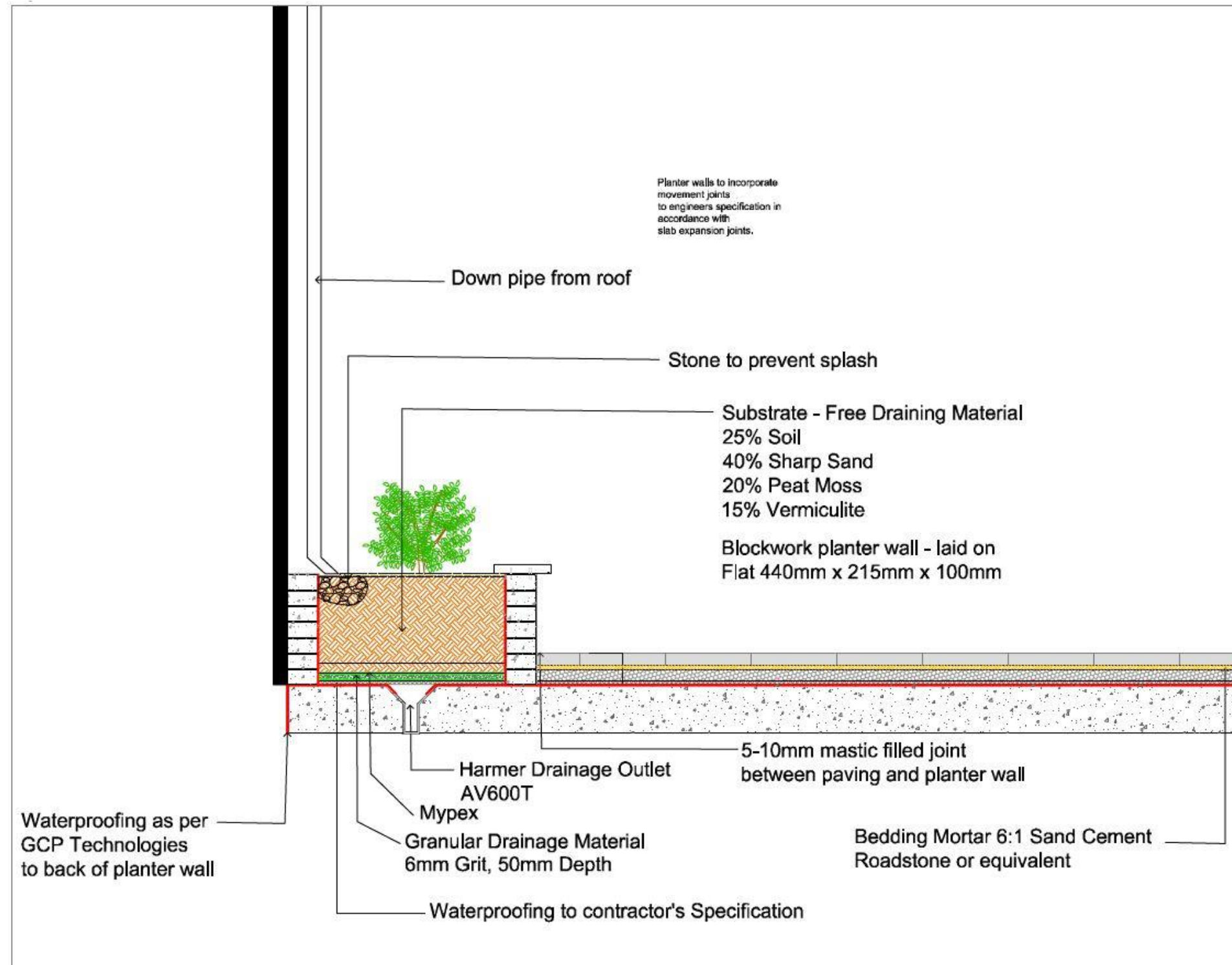

- Provides treatment at source
- Provides treatment of water, cleaning and reducing amount of hydrocarbons.
- Plants soak up excess water
- Rain gardens to provide treatment of water from roof.



RMDA

LANDSCAPE ARCHITECTS & CONSULTANTS

Raised Planter Detail

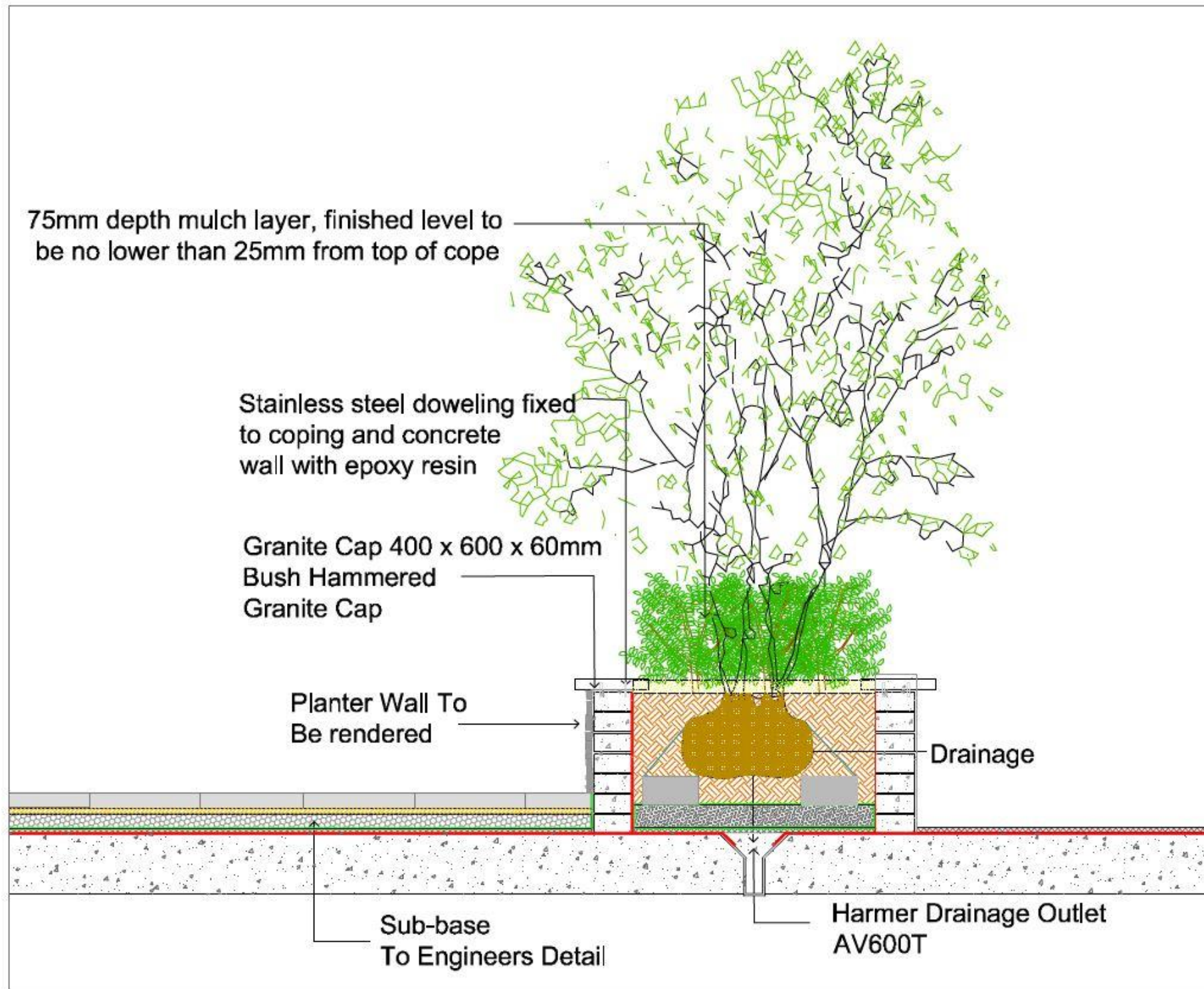

RMDA

LANDSCAPE ARCHITECTS & CONSULTANTS

Podium Planters – Public Realm

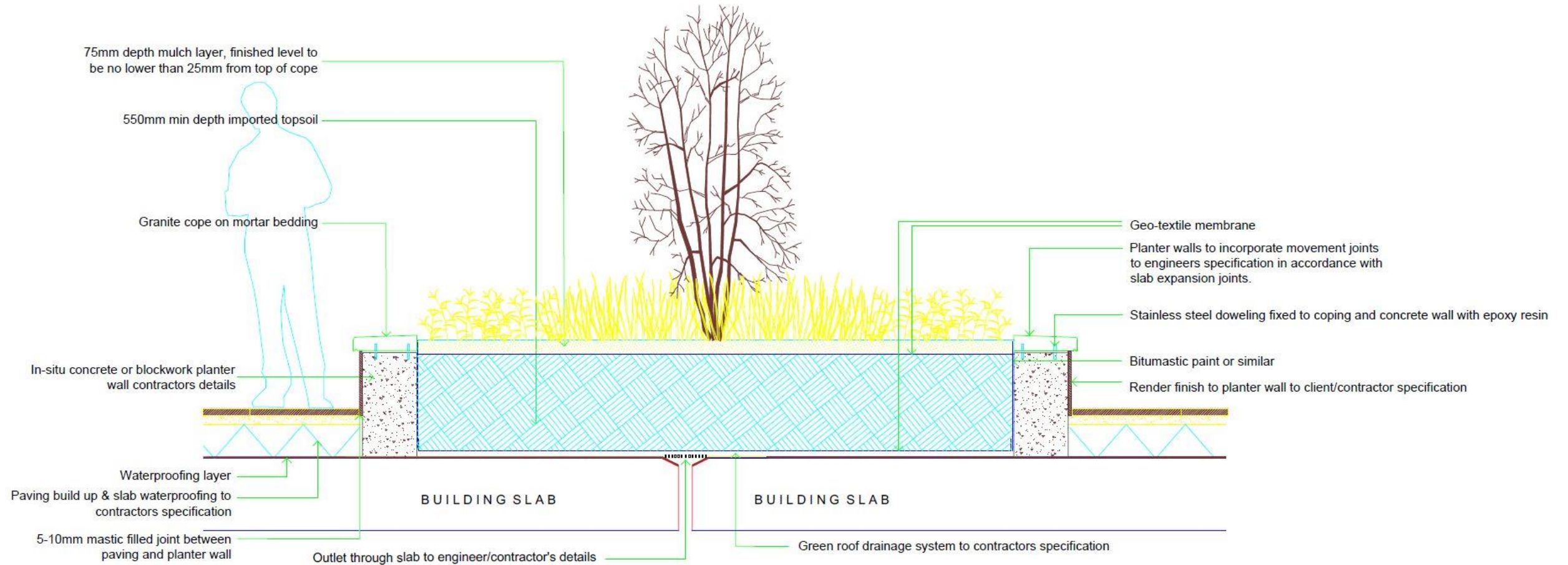

01
D08

Typical section through planter - podium slab build up

1:20



- Provides treatment at source
- Provides treatment of water, cleaning and reducing amount of hydrocarbons.
- Plants soak up excess water
- Rain gardens to provide treatment of water from roof.



RMDA

LANDSCAPE ARCHITECTS & CONSULTANTS

Tree Pit

SUDs Approach

Integrated approach, between landscape & Engineering consultant.

- Sustainable development.
- Use of natural materials to clean water & attenuate water.

Private realm

- Rain gardens – flow from root.
- Garden/Courtyards – private suds at source.
- Swale/Amphitheatre

Public realm

- Tree pits.
- Rain garden.
- Permeable paving.



Watering/liquid fertilizing facilitated by means of a perforated plastic pipe(75m diameter) around the rootball, finished with a stop tap collar.

Concrete Path

Base material

Varies

Root barrier

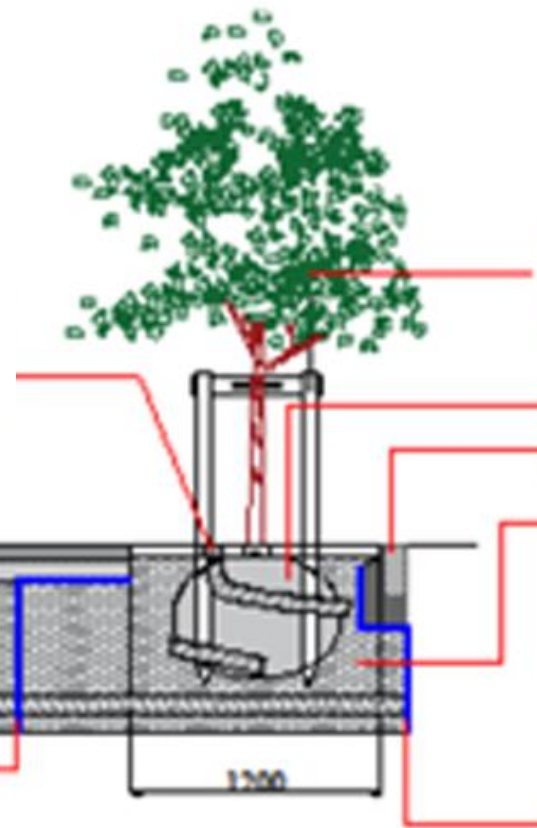

Double timber stakes and brace to provide support to the tree, secured approximately 900mm above ground level with tree tie and collar.

Tree Root-ball

Kerb to roadside set in haunched concrete

Structural Soil

5:1 Mix

Crushed angular stone (20mm-

60mm) : Topsoil

Stone fines excluded.

Running continuous where possible in line with avenue tree planting

Root barrier



RMDA

LANDSCAPE ARCHITECTS & CONSULTANTS

Tree Pit – use of gully system on the road

GREEN STREETS: STORMWATER TREE TRENCH

Street View



Subgrade View

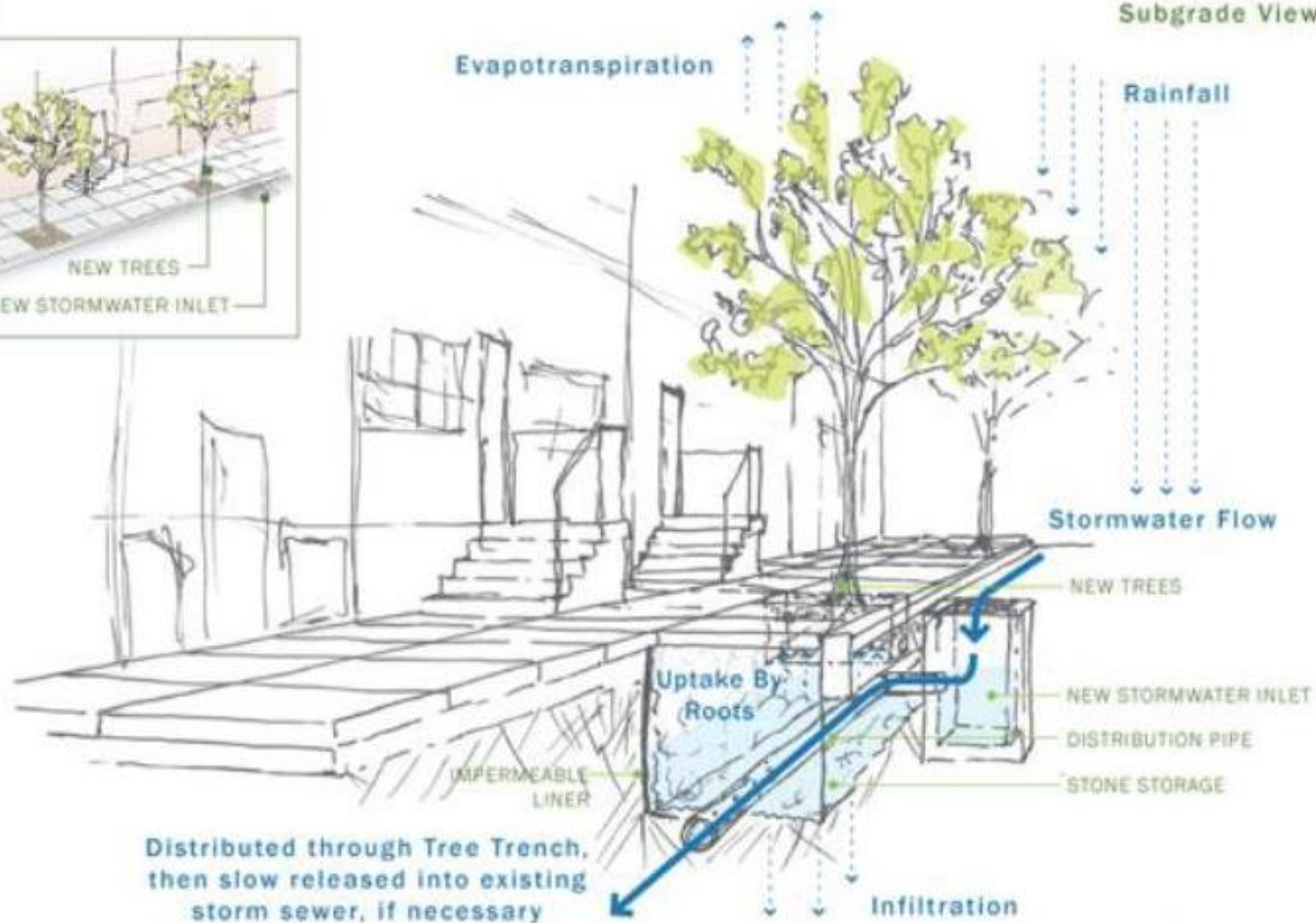

RMDA

LANDSCAPE ARCHITECTS & CONSULTANTS

Tree Pit – Public Realm

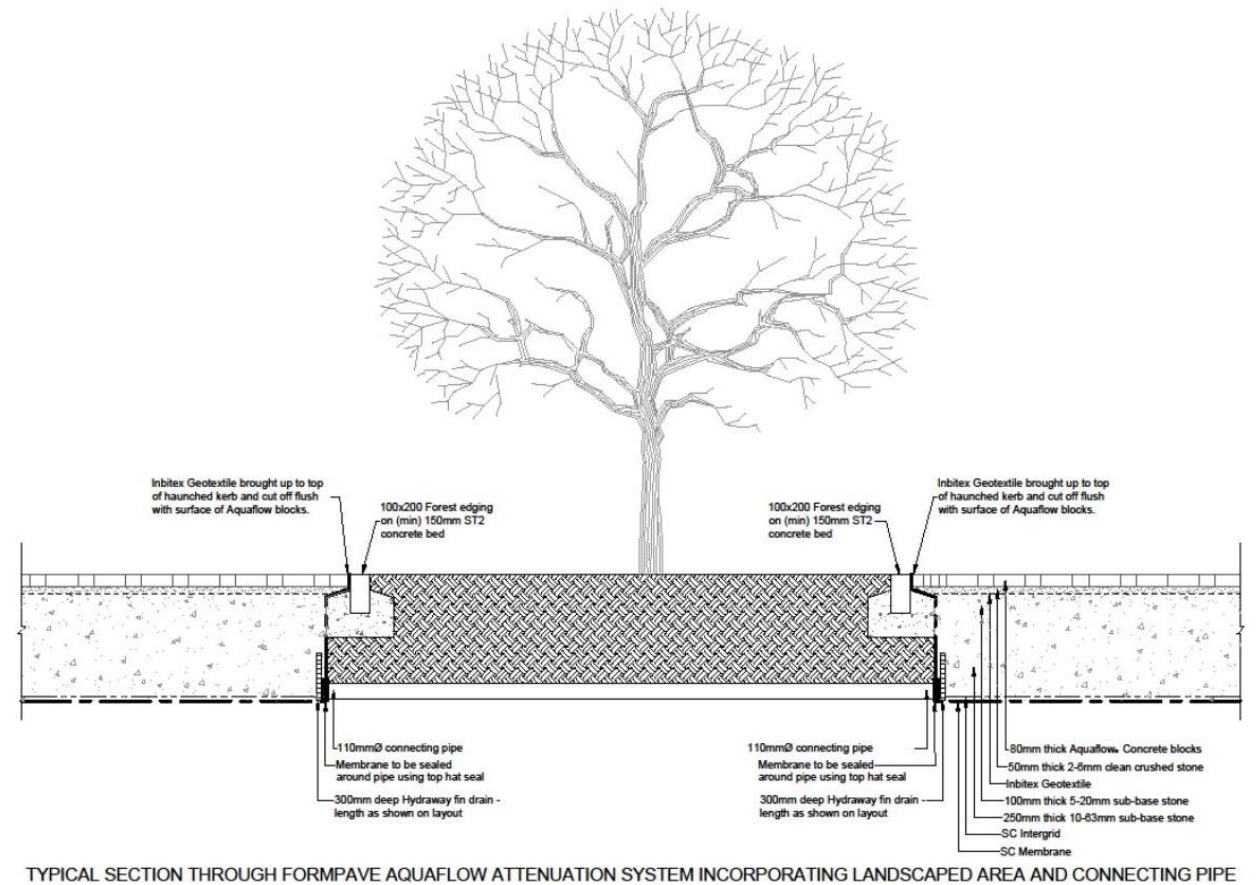
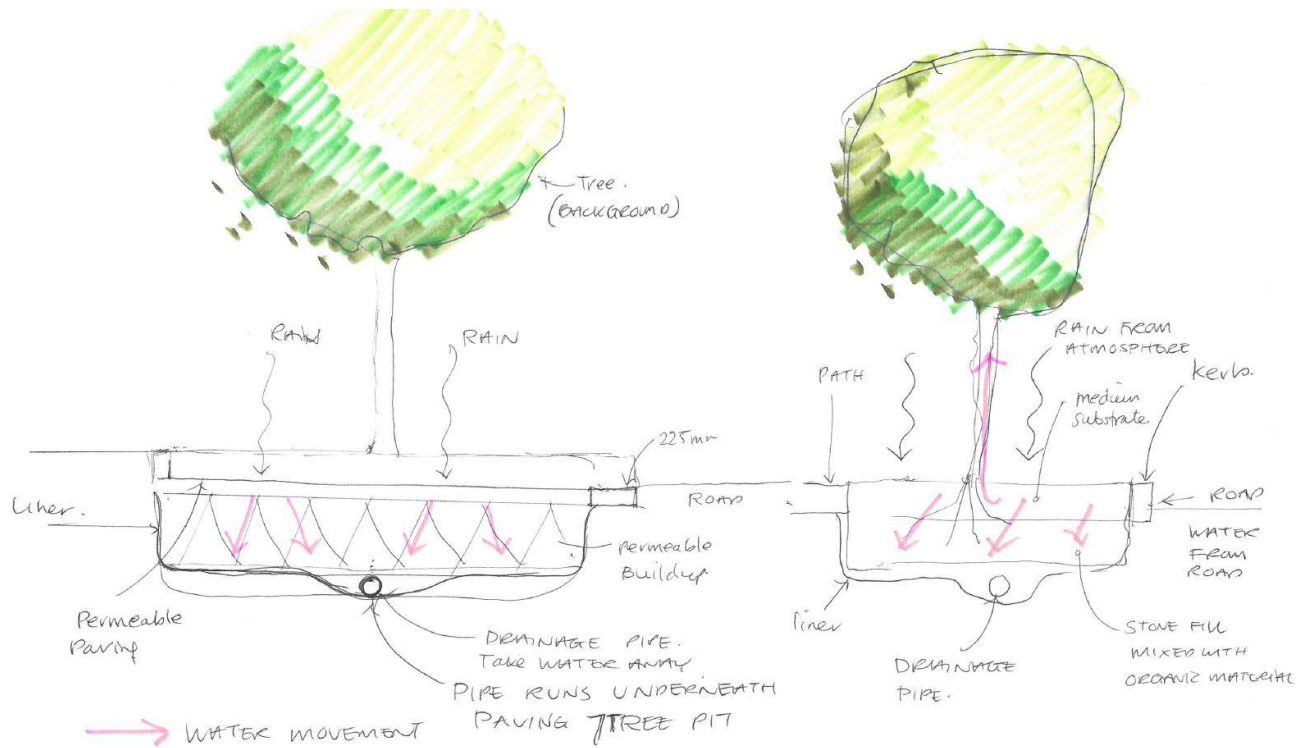

RMDA

LANDSCAPE ARCHITECTS & CONSULTANTS

Defensive Zone Detail

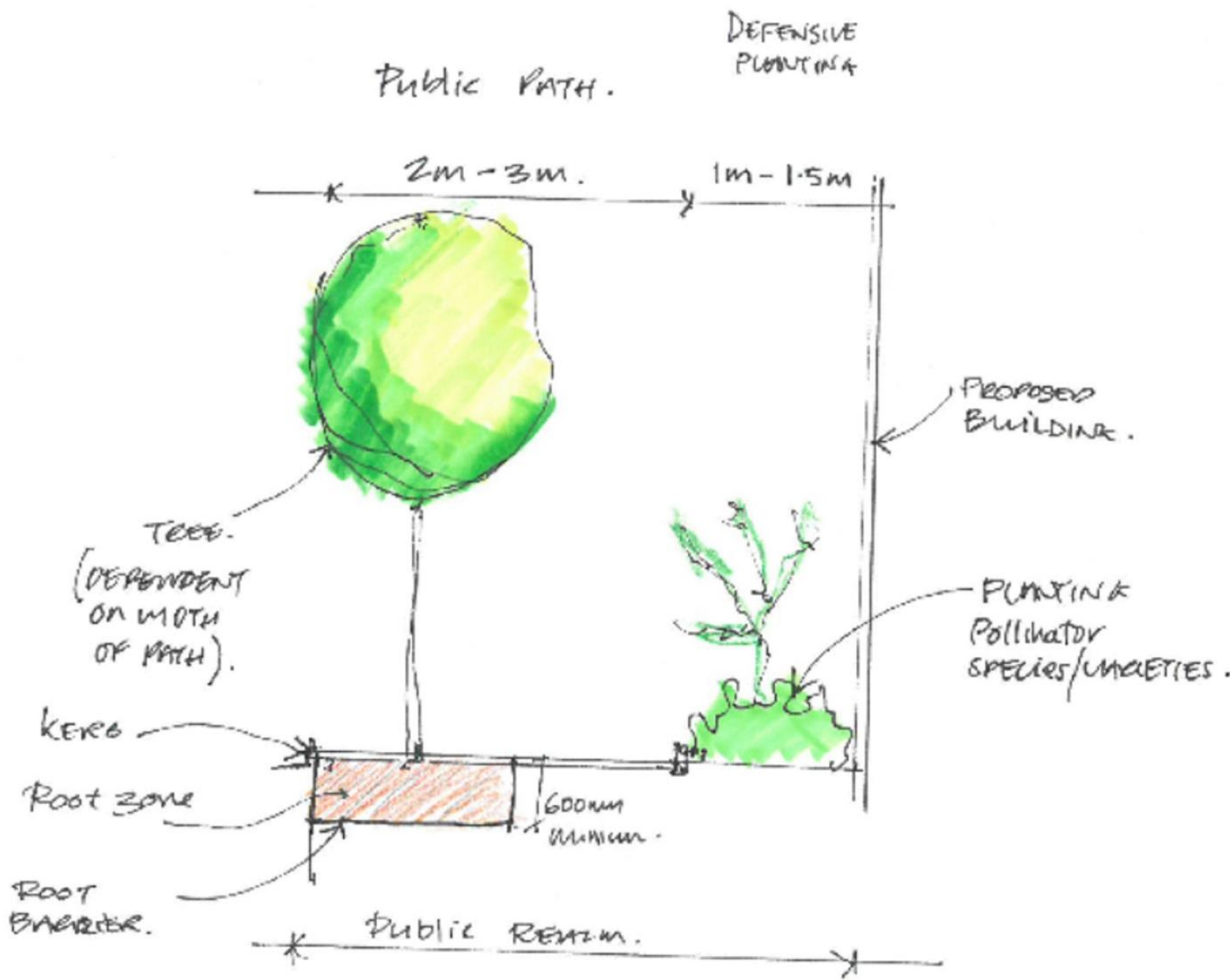

RMDA

LANDSCAPE ARCHITECTS & CONSULTANTS

Landscape Specifications

H1 - Hedgerow Planting Detail



Hedge mix
60-90mm

100% *Elaeagnus x ebbingei*

50 x 50 stake tied with a single rubber gut tie.
2 rows @ 500mm centres -400mm apart,

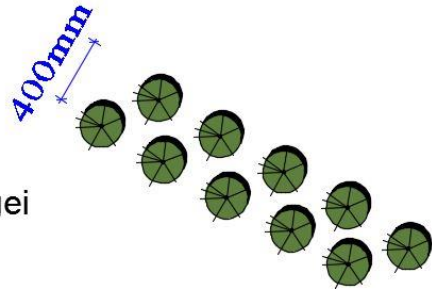

H2 Proposed Native Hedgerow Planting Mix



Boundary detail - Hedge mix Whips, 60 - 90cm
50% *Craetagus monogyna*
35% *Prunus spinosa*
5% *Ilex aquifolium*
5% *Rosa canina*
5% *Lonicera periclymenum* 'Graham Thomas'

50 x 50 stake tied with a single rubber gut tie.
2 rows 400mm apart, 600mm centres

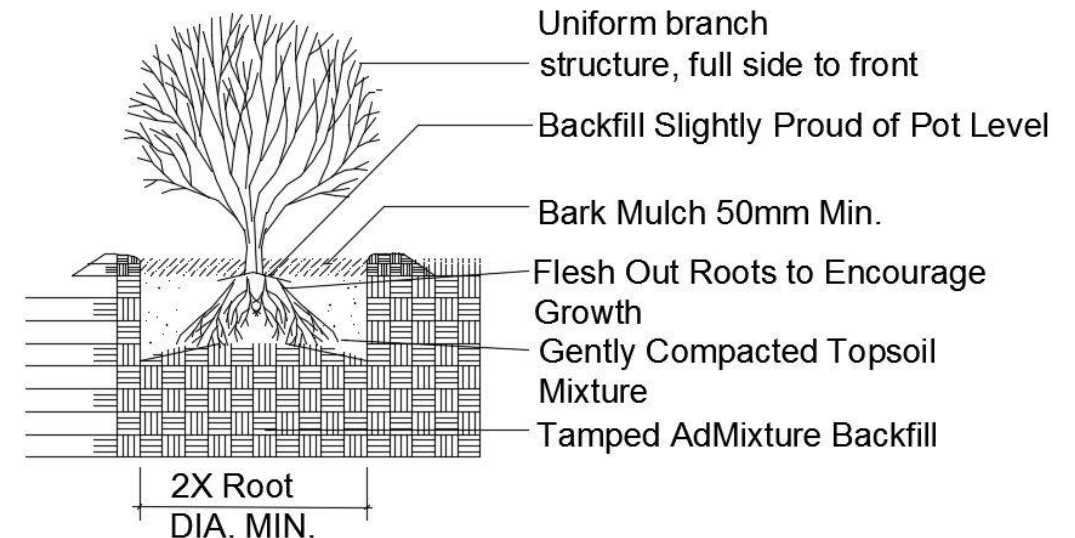
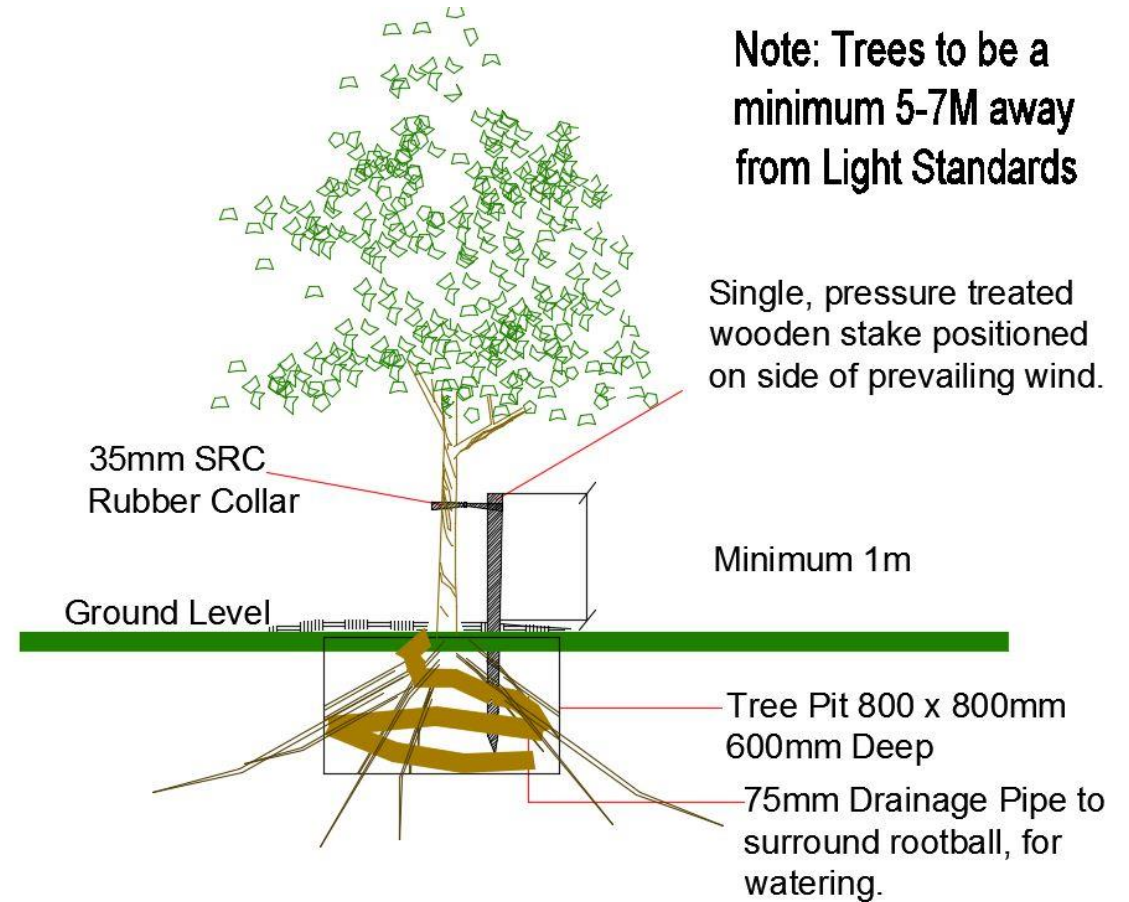
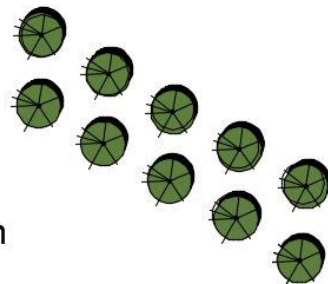

RMDA

LANDSCAPE ARCHITECTS & CONSULTANTS

Landscape Specifications

SCHEDULE OF IMPLEMENTATION:

1. ALL TREE AND HEDGEROW PLANTING IS TO BE CARRIED OUT DURING THE FIRST WINTER SEASON, I.E. NOVEMBER TO FEBRUARY INCLUSIVE.
2. ALL LAWN AREAS ARE TO BE PREPARED AND SEEDDED DURING THE GROWING SEASON, I.E. APRIL TO OCTOBER INCLUSIVE.
3. ALL CONTAINERISED SHRUB PLANTING MAY BE CARRIED OUT AT ANY TIME OF WHEN SOIL IS NOT FROZEN, WATERLOGGED OR EXCESSIVELY DRY.

PLANTING NOTES:

ALL TREES, SHRUBS AND HEDGEROW PLANTS SHALL COMPLY WITH BS 3936, SPECIFICATION FOR NURSERY STOCK. ALL PRE-PLANTING SITE PREPARATION, PLANTING AND POST PLANTING MAINTENANCE WORKS SHALL BE CARRIED OUT IN ACCORDANCE WITH THE REQUIREMENTS OF BS 4428 (1989) CODE OF PRACTICE FOR GENERAL LANDSCAPE OPERATIONS (EXCLUDING HARD SURFACES).

ALL NEW TREE PLANTING SHALL BE POSITIONED IN ACCORDANCE WITH THE REQUIREMENTS OF TABLE 3 OF BS 5837: 2005 TREE IN RELATION TO CONSTRUCTION: RECOMMENDATIONS, WHICH SPECIFIES MINIMUM DISTANCES BETWEEN NEW PLANTING AND STRUCTURES.

Tree Planting Detail

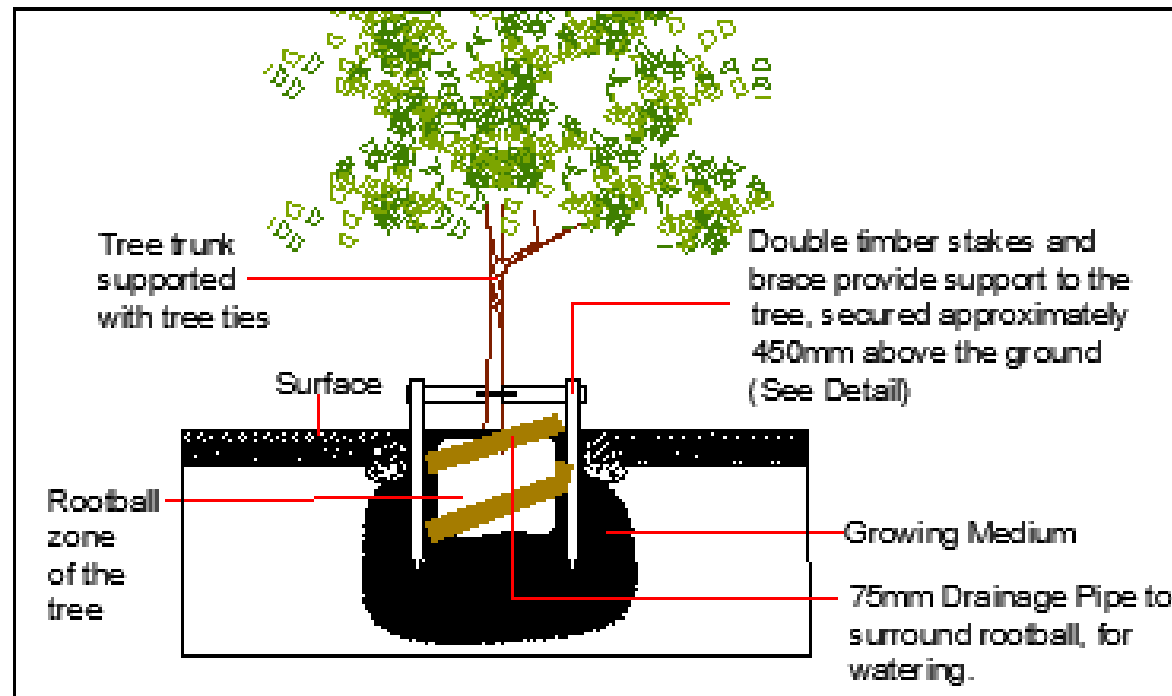

Typical double Tree staking detail

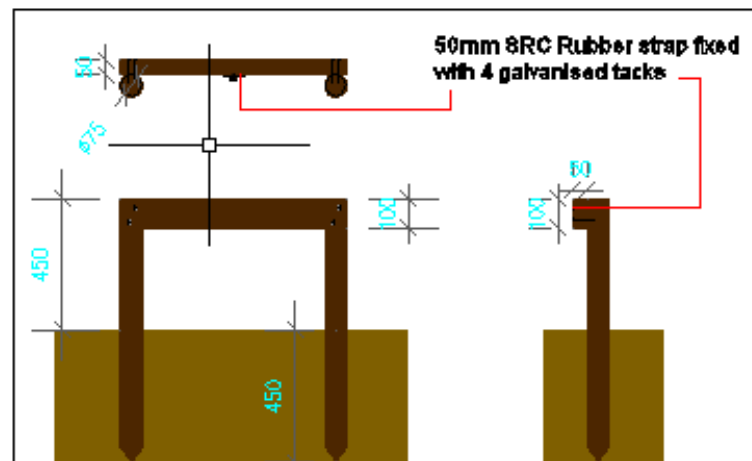

Tree Planting



Tree Planting



RMDA

LANDSCAPE ARCHITECTS & CONSULTANTS

Green Wall Detail – Block 15



Plan Block 15 – Green wall to rear of cinema

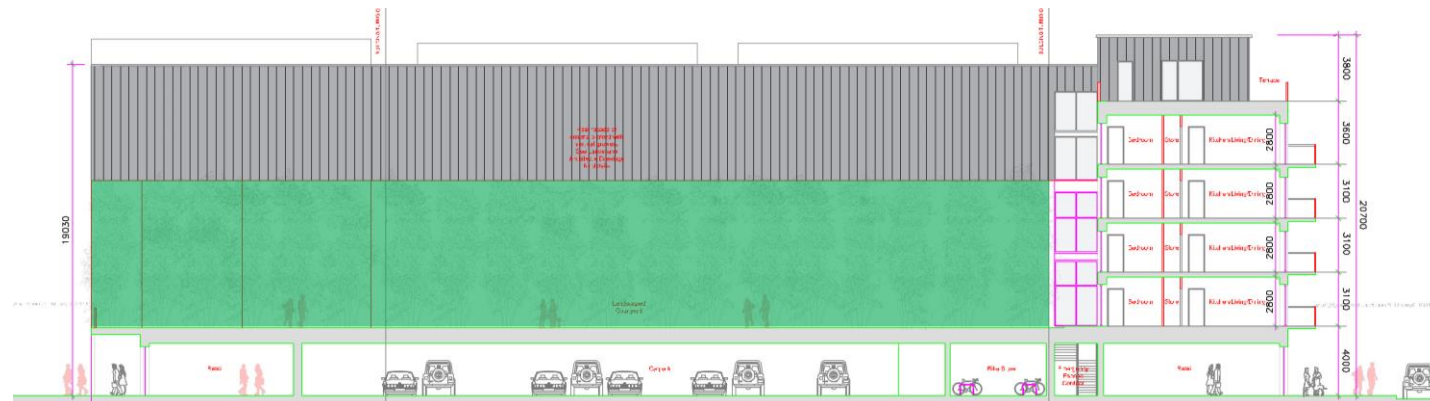

Sectional elevation – rear of cinema elevation

Living green walls enhance the Visual Appearance of Buildings. Improve air quality, increases alertness and energy levels of Residents

- Living green walls are natural air-filters.
- Living green walls, the structures can reduce noise levels in buildings.
- Remove particular matter from air
- Reduce heat in urban environment
- Provide texture in landscape
- Mental health benefits
- Sustainable urban living



RMDA

LANDSCAPE ARCHITECTS & CONSULTANTS

Green Wall Detail – Block 15

Green Wall Detail (Scale 1:10)

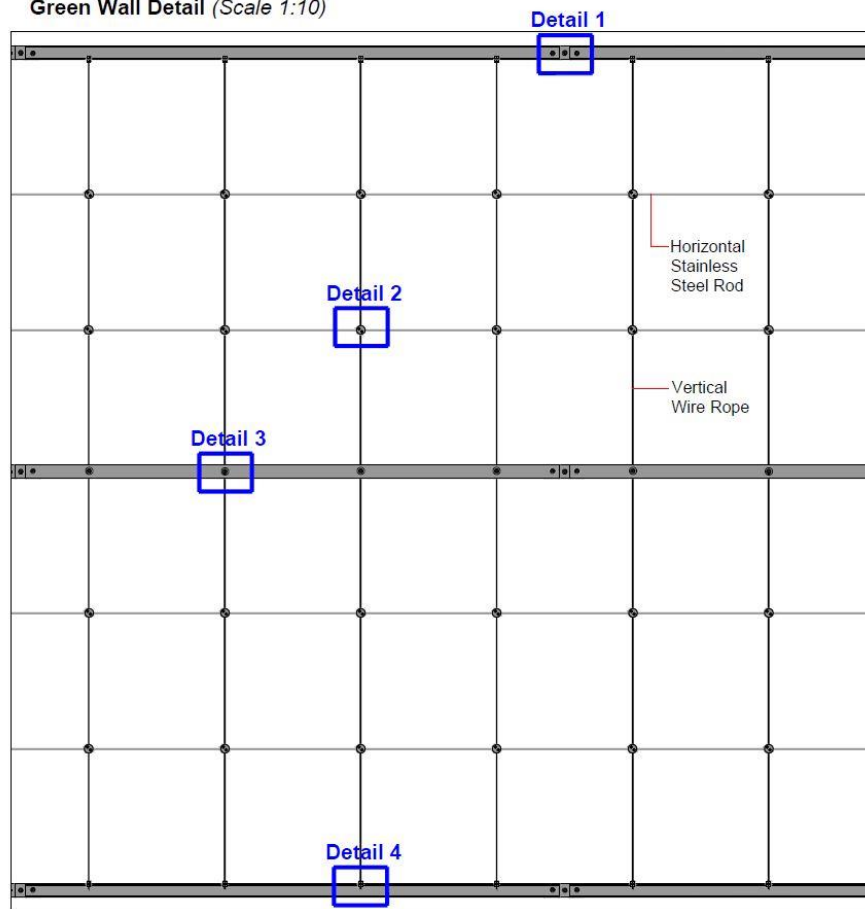

Before:

After:

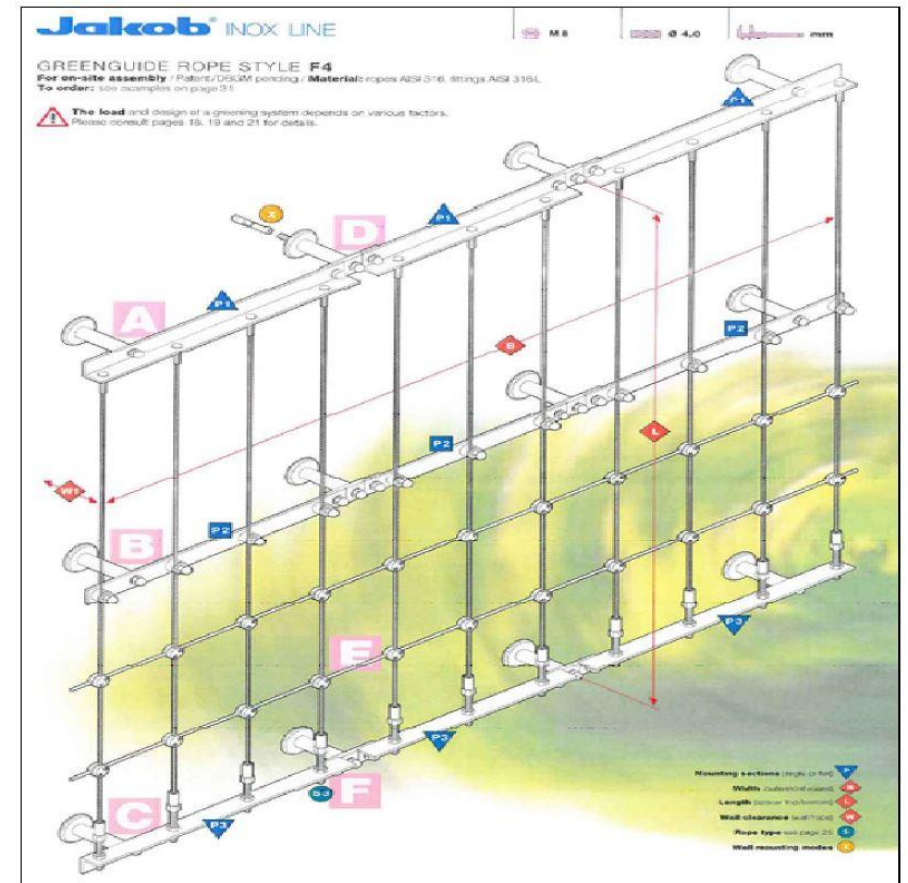

Detail 1 Section Connection (Scale 1:2)

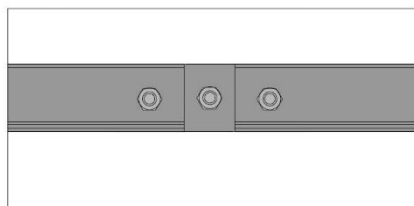

Detail 2 CrossClamp (Scale 1:2)

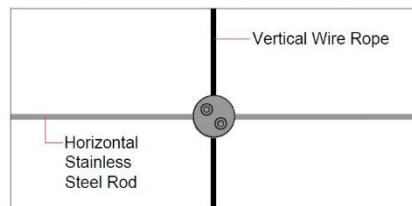

Detail 3 Overload Clamp (Scale 1:2)

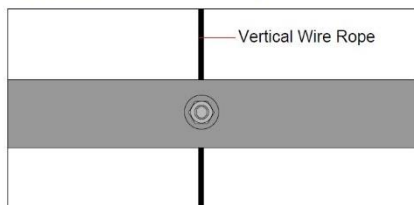

Detail 4 Bottom Mounting (Scale 1:2)

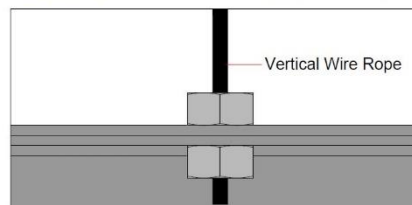

Proposed Climbers for Jakob Green Wall System

- Cissus striata 20Ltr.
- Clematis armandii 25Ltr.
- Wisteria floribunda 40Ltr.
- Parthenocissus tricuspidata 20Ltr.

Single Row @ 300mm centres Planted Together

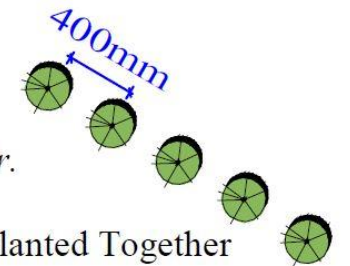

RMDA

LANDSCAPE ARCHITECTS & CONSULTANTS

Proposed & Existing Surface Materials



Tegula 175x140x50mm & 140x140x50mm charcoal



Retro 190x50x60mm Heather



Dust Path



Guangze granite 200x100 for Market Street (to match existing in Station Square)



Paving Flag 600x400 grey with cobble edge (to match existing on Main Street)



Pedesta 200x100x50mm Bracken



Sienna 208x173x50mm & 173x173x50mm Silver



Fusion 300x200x60mm Graphite



Silver surface drain (to match existing in Station Square)



Hydropave Pedesta for Car Parking 200x100x60 Brindle with charcoal border (to match existing parking spaces)



Pembury 200x100x50mm Charcoal



Tegula 175x140x50 & 140x140x50mm Bracken



Beige tarmac



Brushed Concrete with trowel edge finish (streets)



RMDA

LANDSCAPE ARCHITECTS & CONSULTANTS